



MW 45-12

12V 45Ah

Compliance with standards:

- PN-EN 60896-21:2007
- PN-EN 60896-22:2007
- PN-EN 61056-1:2008
- PN-EN 61056-2:2003(U)
- PN-E-83016:1999



Batteries **MW Power** type **MW** are designed for use both in emergency power supply systems and other applications where the battery operates cyclically. Recommended use of the batteries: UPS backup power supply, automation systems, cash registers, as a source of energy in portable devices, charging power engines and other equipment in a cyclic mode. For discharges of 50% can reach 500 cycles.

Designed service life 6-9 years to range of 20-25 ° C.

Specification

Nominal voltage	12V	
Nominal capacity	45,0 Ah	
Dimen- sions	Lenght	198 mm
	Width	166 mm
	Height	171 mm
	Total he- ight	171 mm
Weight	14,20 kg	

Characteristic

Capacity for 25 ° C and cut-off voltage 10.5 V	20h	45,0 Ah
	10h	42,75 Ah
	5h	38,25 Ah
Internal resistance	charged battery	7,4 mΩ
Capacity	for 20°C	100%
	for 0°C	85%
	for -15°C	65%
Self-discharge	3 m-ths	91%
	6 m-ths	82%
	12 m-ths	64%
Terminal	Bolt M6	
Charging	Standby use	13,50-13,80V
	Cyclic use	14,40-15,00V
Max. charge current	14,0 A	
Max. discharge current	540A (5 sec.)	
Temperatures of work:		
Discharging: -20°C ÷ 50°C		
Charging: -20°C ÷ 50°C		
Storage: -20°C ÷ 50°C		

Dimensions

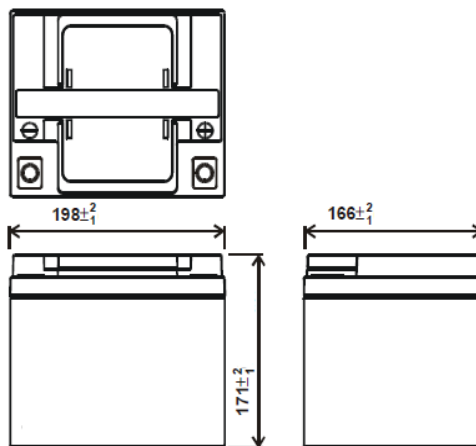

Input-discharge at 25 ° C

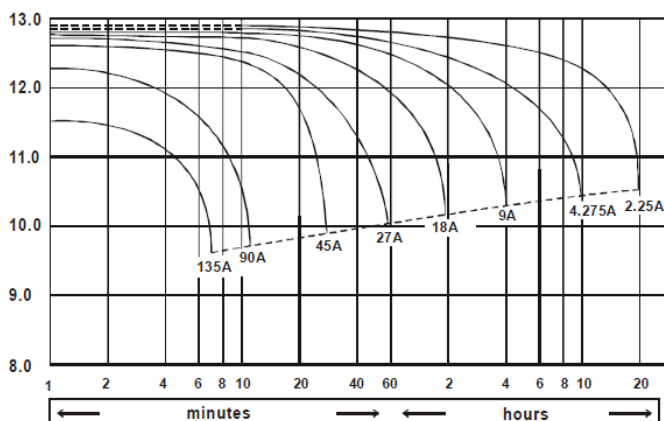

Terminal

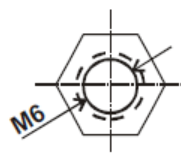

Zalec. M6: 5.39 N-m (55kg-cm)

Max. M6: 8.82 N-m (90kg-cm)

MPL[®]
E N E R G Y